

MC-56(BOCA-50) Setting Descriptions

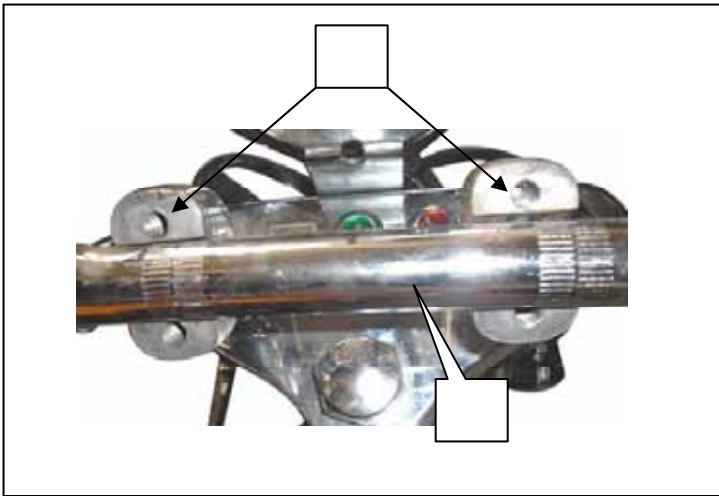
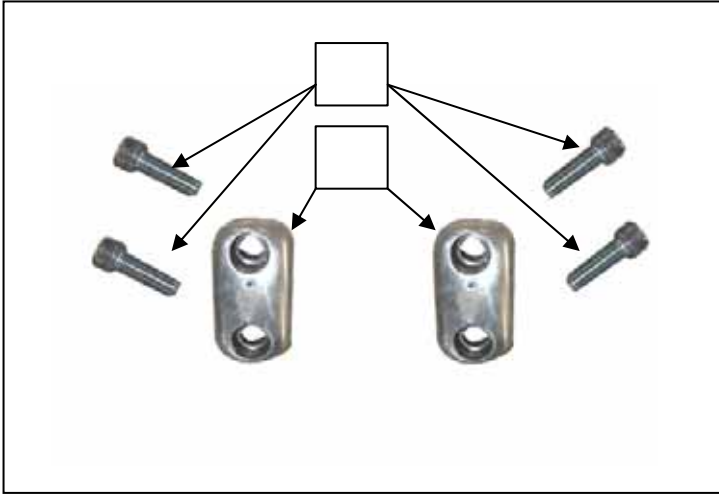

STEP ONE : Handle-bar Setting

Ref. No.	Part Name	Quantity	Description	Position
	Handle-bar Clip (Up)	2		
	Bolt	4	M8x25	
	Handle-bar Clip (Down)	2		
	Handle-bar	1		

- 1、 Clip to with .
- 2、 Fasten and to with .

MC-56(BOCA-50) Setting Descriptions

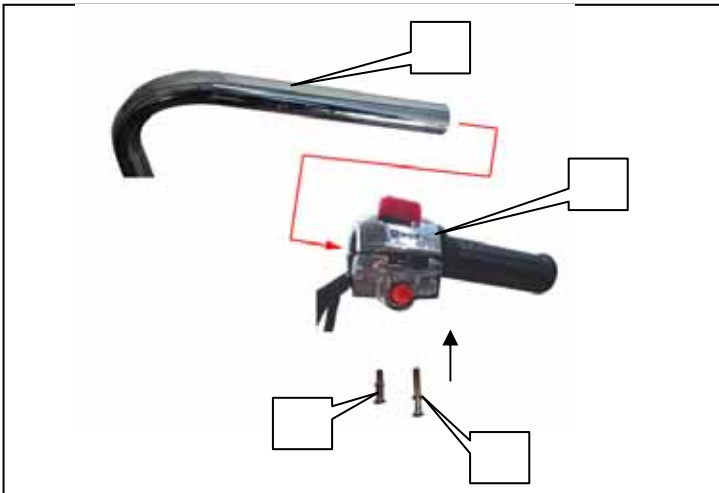
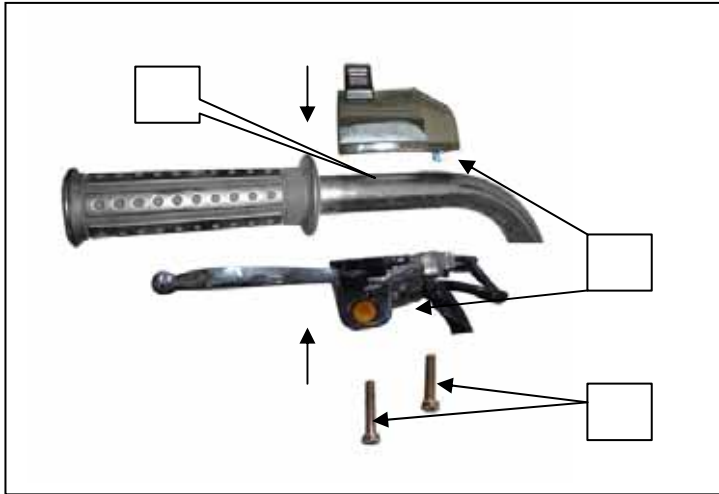

STEP TWO : Left\Right Switch Setting

Ref. No.	Part Name	Quantity	Description	Position
	Left Switch	1		
	Handle-bar Left	1		
	Bolt	2	M5×28	
	Handle-bar Right	1		
	Right Switch	1		
	Bolt	1	M5×25	
	Bolt	1	M5×38	

- 1、 Disconnect and put it on , fasten to with ;
- 2、 Disconnect and put it on , fasten to with and ;

MC-56(BOCA-50) Setting Descriptions

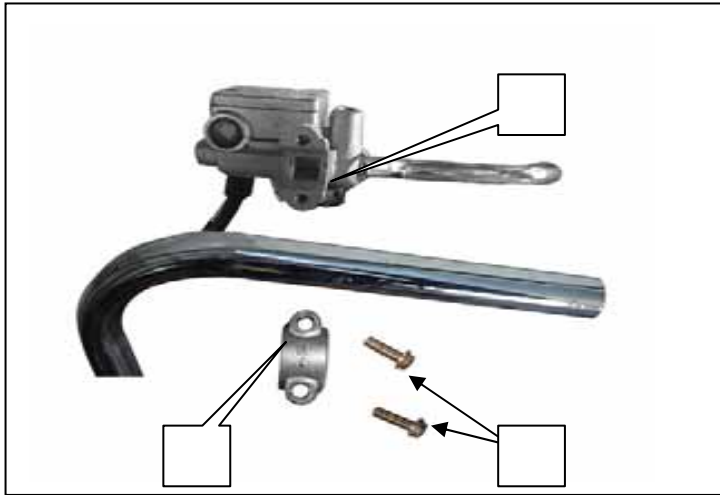

STEP THREE : Dish Pump Setting

Ref. No.	Part Name	Quantity	Description	Position
	Hydraulic Pump(Up)	1		
	Hydraulic Pump Clip	1		
	Bolt	2	M6×22	
	Handle-bar right	1		

- 1、 Put on ;
- 2、 Fasten and to with .

MC-56(BOCA-50) Setting Descriptions

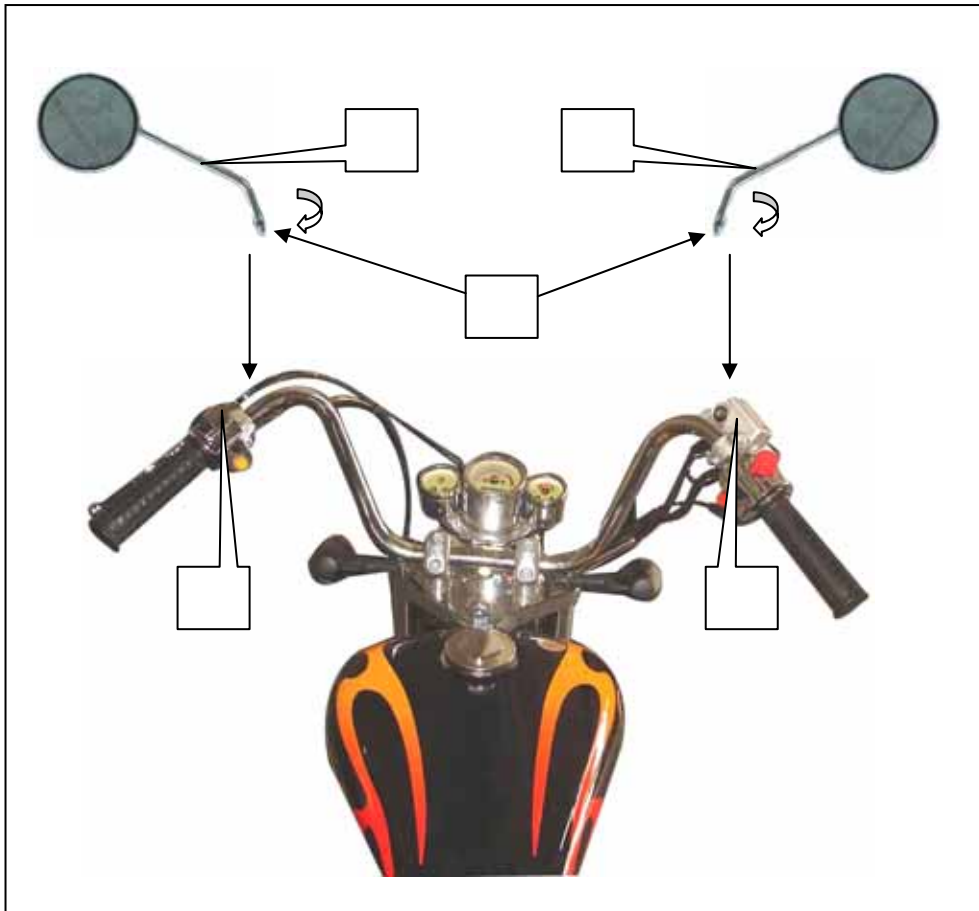

STEP Four : Rear mirror Setting

Ref. No.	Part Name	Quantity	Description	Position
	Left Rear Mirror	1		
	Right Rear Mirror	1		
	Left Switch	1		
	Hydraulic Pump (Up)	1		
	Nut	2	M10	

- 1、 Set to the hole of , fasten according to the direction.
- 2、 Set to the hole of , fasten according to the direction.

MC-56(BOCA-50) Setting Descriptions

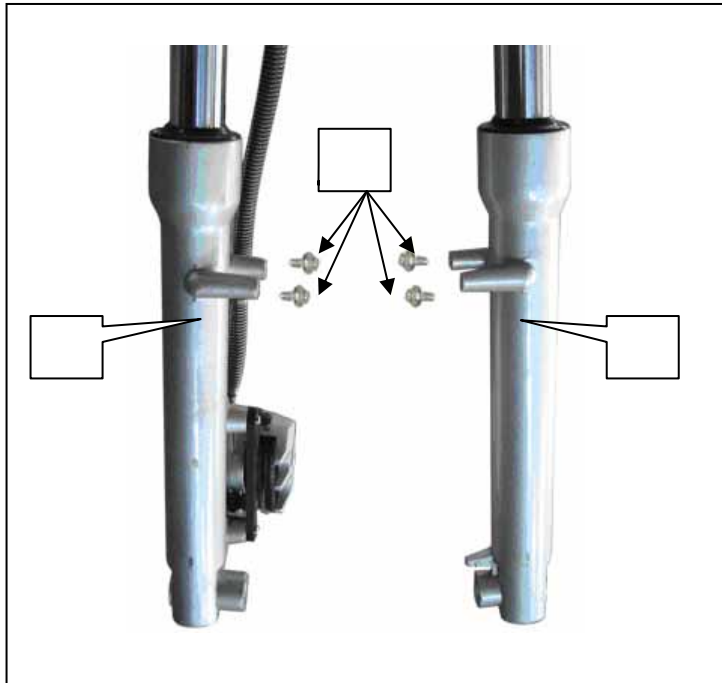
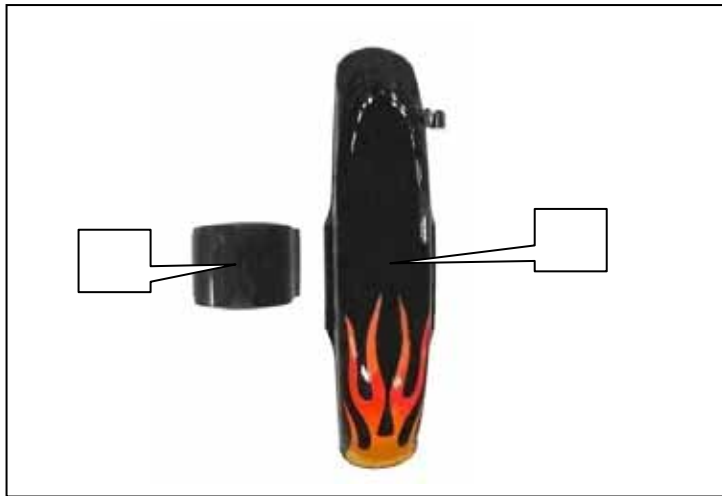

STEP Five : Front Fender Setting

Ref. No.	Part Name	Quantity	Description	Position
	Front Fender	1		
	Fix Frame of Front Fender	1		
	Right, Front Fork	1		
	Left, Front Fork	1		
	Bolt	4	M6×20	

- 1、 Set into , hole to hole.
- 2、 Put and to the middle of and .
- 3、 Fasten and to and with .

MC-56(BOCA-50) Setting Descriptions

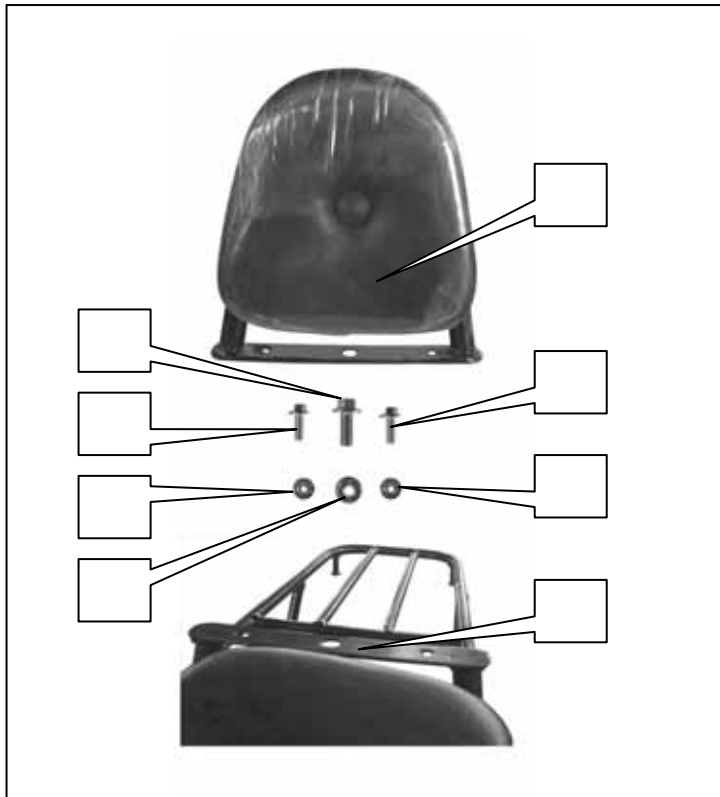

STEP SIX : Backrest Setting

Ref. No.	Part Name	Quantity	Description	Position
	Backrest	1		
	Bolt	1	M8x20	
	Nut	1	M8	
	Bolt	2	M6x16	
	Nut	2	M6	
	Rear Shelf	1		

- 1、 Put on , hole to hole ,
- 2、 Fasten to with 、 and 、 .

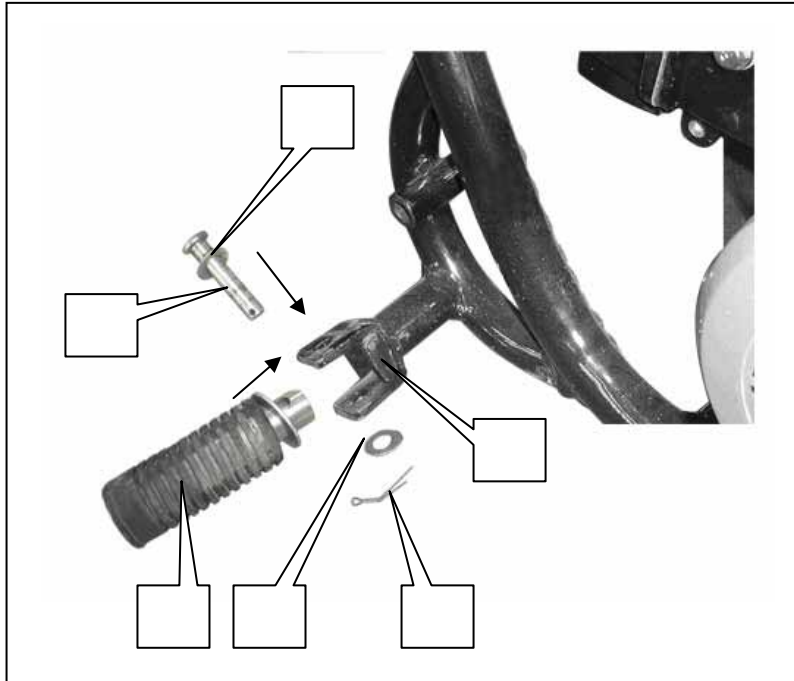

STEP SEVEN : Left Footrest, Front Setting

Ref. No.	Part Name	Quantity	Description	Position
	Left Footrest, Front	1		
	Pin	1	Ø8x40	
	Washer	1	Ø8	
	Fixation, frame	1		
	Peg	1	M1.2x15	
	Washer	1	Ø8	

- 1、 Put into the cover of .
- 2、 Put and into .
- 3、 Fasten to with and .

MC-56(BOCA-50) Setting Descriptions

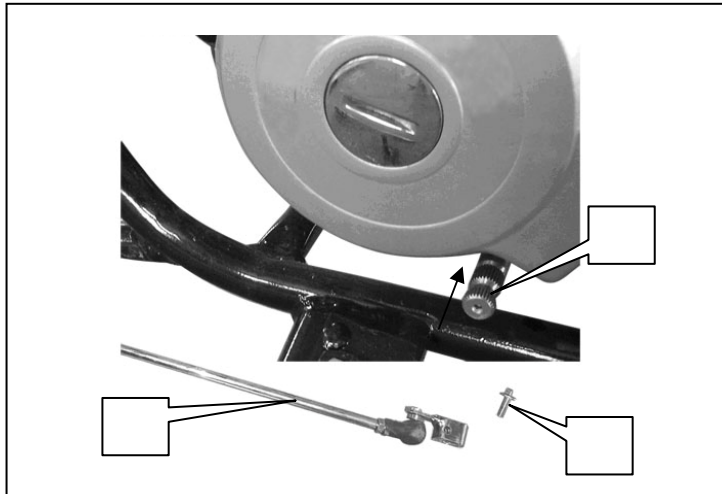
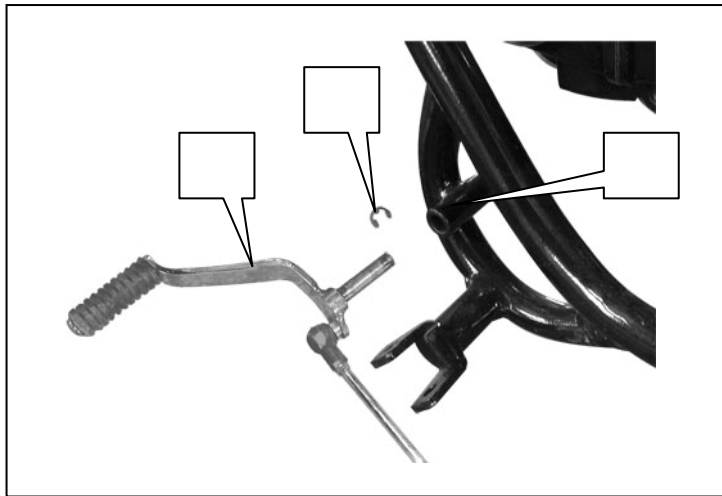

STEP EIGHT : Gear Shift Setting

Ref. No.	Part Name	Quantity	Description	Position
	Gear Shift	1		
	Clip	1		
	Fixation, frame	1		
	Bolt	1	M6×15	
	Shift Axes	1		

- 1、 Plug the front of into , clip with .
- 2、 Set the rear of to , fasten with .

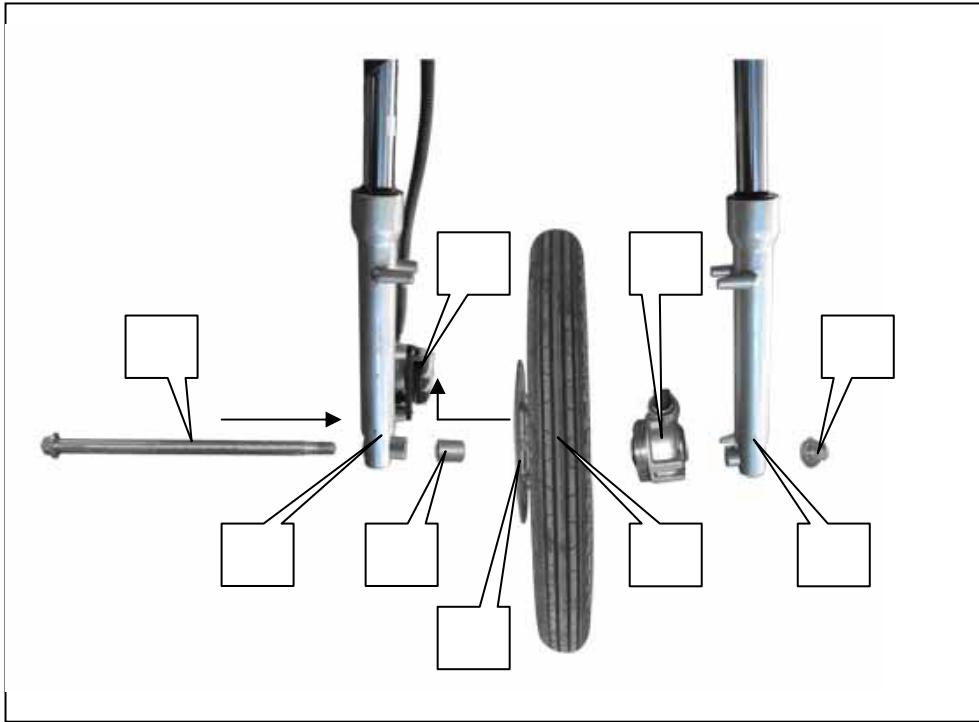

STEP NINE : Front Wheel Setting

Ref. No.	Part Name	Quantity	Description	Position
	Axes, Front	1		
	Steel Sheath	1		
	Nut	1	M12x1.5	
	Right, Front Fork	1		
	Left, Front Fork	1		
	Arithmometer	1		
	Front Wheel	1		
	Front Brake Hydraulic Pump	1		
	Front brake disk	1		

- 1、 Set into 's middle rubber ring.
- 2、 Clip to with the set of and .
- 3、 Connect to , , , , and fasten with .