

# TAHITI-150 INSTRUCTION OF THE INSTALLATION

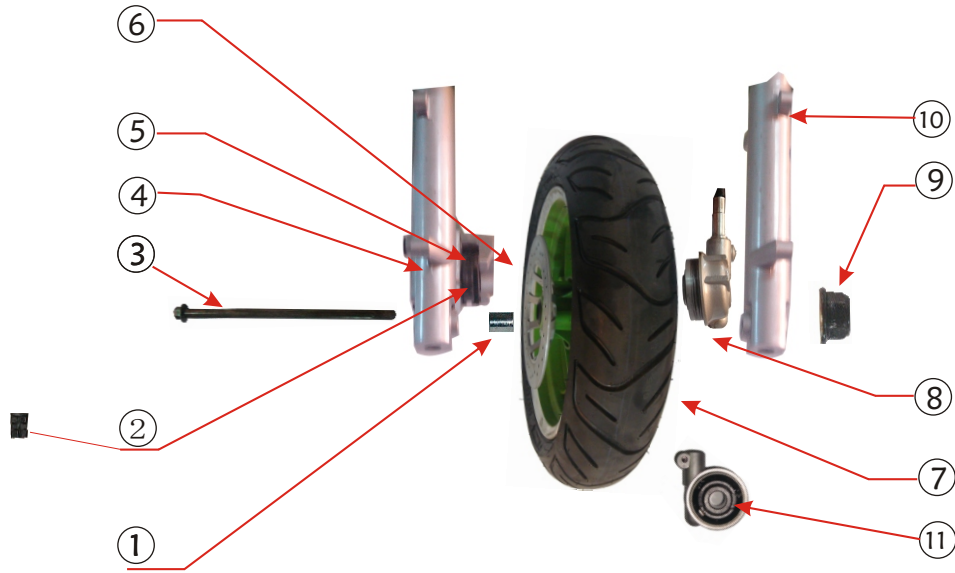

# INSTALL FRONT WHEEL (ONE)

Description	Quantity	Specification	Remark	Twist power
① FR wheel bush	1	∅10.5×∅23×21	Through front axle of ③	
② Disc pad	1		Block in ⑤	
③ FR wheel Axle	1	M12×285	Fix in iron frame packing	
④ Left shock absorber	1		On motorcycle	
⑤ Front brake caliper	1		Fix on ④	
⑥ Brake Disc	1		Install in Fr wheel of ⑦	
⑦ Fr wheel	1		In carton	
⑧ Speedometer Gear	1		On motorcycle	
⑨ Nut	1	M17×1.25	Fix on the front axle wheel ③	20blf
⑩ Right shock absorber	1		On motorcylce	



## Install step:

1. Take down ① ③ ⑨ from the iron frame packing.
2. Put ③ into ⑦ and through middle of ⑦ 's hole.
3. Connect ④ ⑦ ⑧ by ③ and fasten by ⑨.

### Attention:

1. Take away ② from ⑤ and block ⑥ into ⑤.
2. ① which is in ⑧ must be put into the middle slot of ⑦, ⑩ must be locked in the slot of ⑧, referring the drawing installing turn way.
3. ⑨ should be fixed by 20BLF°
4. Running the front wheel clockwise to check whether it can be moved freely after installation, and to check whether the speedometer working properly.

# INSTALL HANDLEBAR (TWO)

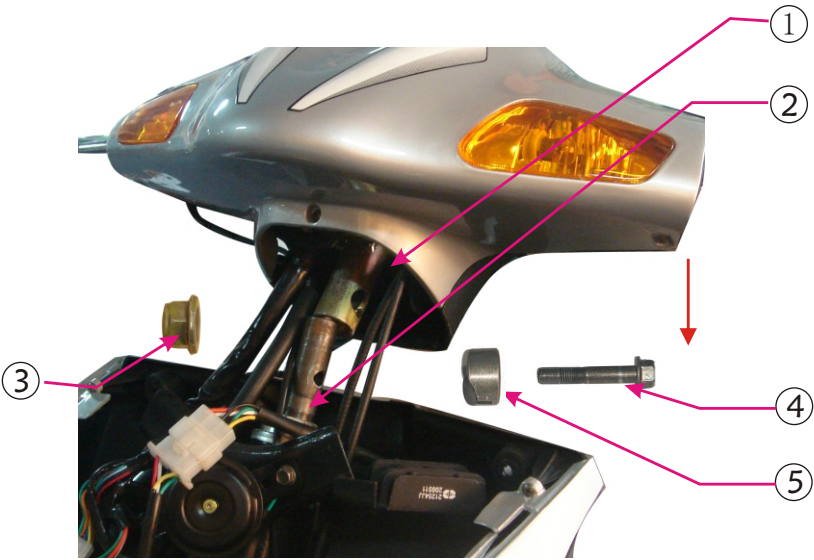

	Description	Quantity	Specification	Remark	Twist power
①	Steering handle	1		On motorcycle	
②	Steering pole	1		On motorcycle	
③	M14 Nut	1	M14×1.25	Fix on the steering handle ①	20b1f
④	M10×55 Bolt	1		Fix on the steering handle ①	
⑤	Collar	1		On motorcycle	

## Install step:

1' Take down ③④⑤ from the steering handle.

2. Put ① on ② according the red arrowhead, and ① hole to ② hole .

3' Connect ⑤①② by ④ , and fasten by ③

Attention:

After installation, lift up the steering handle, check and sure without any gap.

# INSTALL FRONT COVER (THREE)

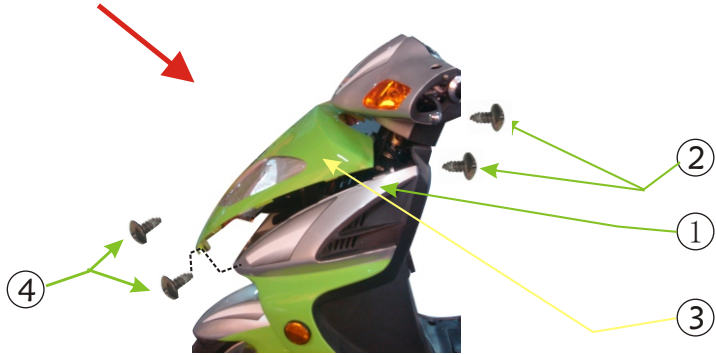
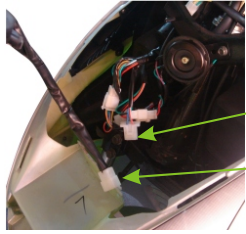

Description	Quantity	Specification	Remark	Twist power
① Body	1		On motorcycle	
② Self-tapped screw	2	ST4.8×16	In toolbox	
③ Front cover	1		On motorcycle	
④ Self-tapped screw	2	ST4.8×16	In toolbox	
⑤ Main wire cord	1			
⑥ Head light wire cord	1			

## Install step:

1. Connect ⑤ and ⑥.
2. Put ③ on ①, referring the drawing.
3. Fasten ①③ by ②④.

### Attention

Put ③ into ① as drawing, ③ must insert ①'s slot.

Pay attention to the clip of ③, and make sure all clips insert ①'s slot, then push up ③, make sure the connection with ① very well.

# INSTALL LUGGAGE CARRIER (FOUR)

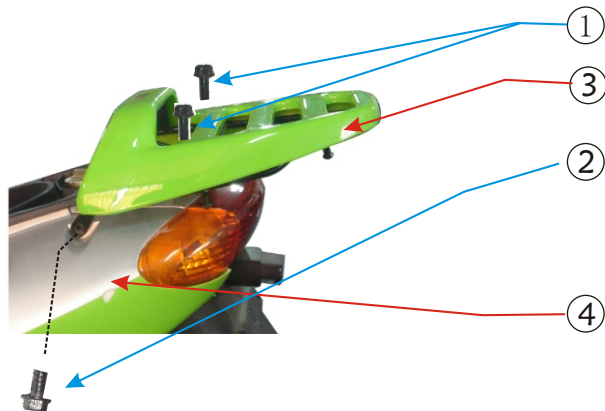

Description	Quantity	Specification	Remark	Twist power
① Bolt	2	M8 × 16	On motorcycle	
② Bolt	2	M6 × 16	On motorcycle	
③ Luggage carrier	1		On motorcycle	
④ Body				

## Install step:

1. Connect ③ ④ by ①②, and fasten them.

# INSTALL REARMIRROR(FIVE)

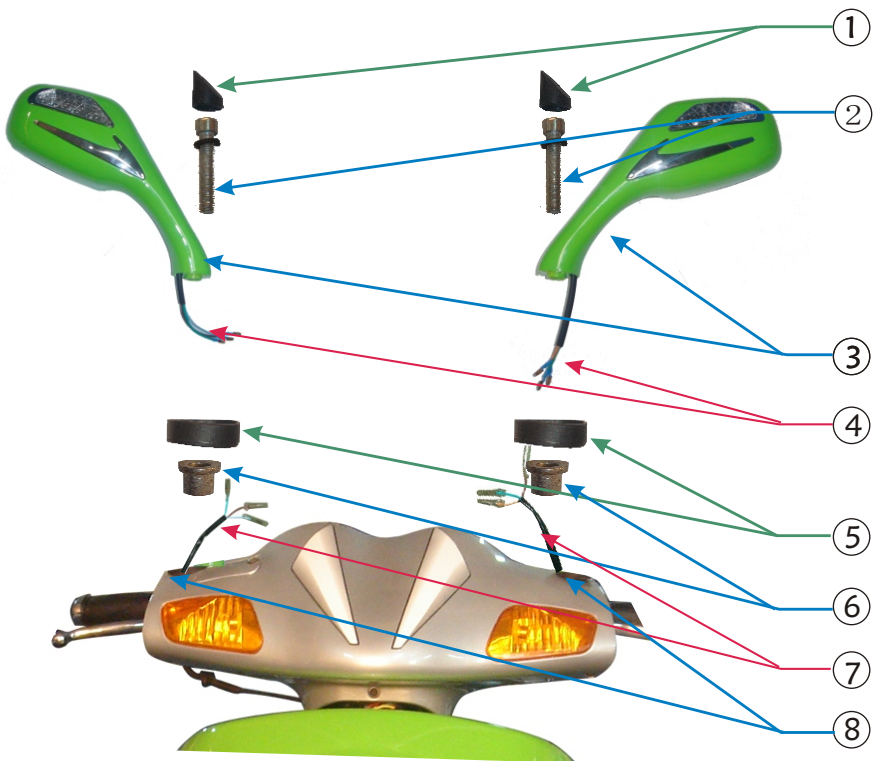

Description	Quantity	Specification	Remark	Twist power
① Waterproof rubber	2		In sundries box	
② Bolt	2	M8×45	In sundries box	
③ Rearview mirror (R&L)	1		In sundries box	
④ Rearview mirror line	2		In sundries box	
⑤ Rubber	2		In sundries box	
⑥ Collar	2		In sundries box	
⑦ Sub-cable	2		On motorcycle	
⑧ Rearview mirror holder	2		On motorcylce	

## Install step:

1. Through ⑤ by ④, then connect with ⑦.
2. Through ③ ⑤ ⑥ by ② then fix on ⑧, adjust the point view of rearview before fastening.
3. Put ① on ②.

Attention:

when connect ④ and ⑦, yellow to yellow, green to green, brown to brown, blue to blue.

# INSTALL LUGGAGE CARRIER (SIX)

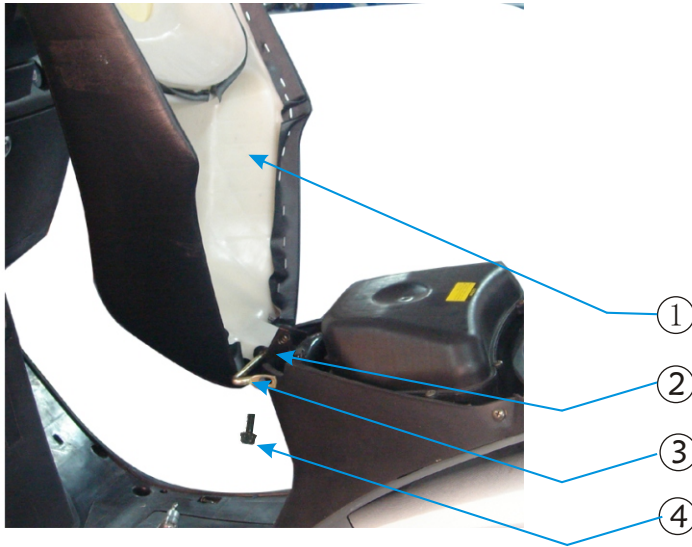

Description	Quantity	Specification	Remark	Twist power
① Cushion	1		In iron frame packing.	
② Cushion bracket	2		On motorcycle	
③ Cushion pin	1		Fix on ②	
④ Bolt		M6 × 12	Fix on ②	

## Install step:

1. Take down ③④ from ②.
2. Fix ① on ② according to the drawing, and through ② and ① by ③, then fasten ③② by ④.

# INSTALL BATTERY (SEVEN)

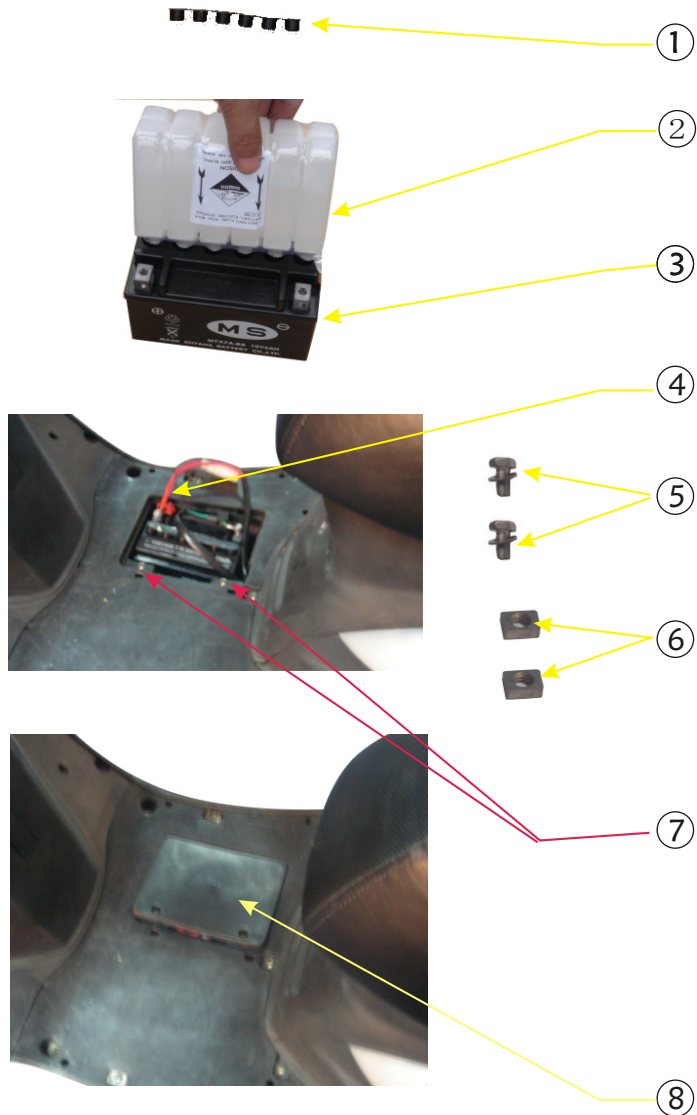

Description	Quantity	Specification	Remark	Twist power
① Battery sealed strip	1		In sundries box	
② Electrolyte	1		In sundries box	
③ Battery	1	12V7h	In sundries box	
④ Battery line			On motorcycle	
⑤ Battery Bolt	2		In sundries box	
⑥ Battery Nut	2		In sundries box	
⑦ Battery cover screw	2		On motorcycle	
⑧ Battery cover	1		In sundries box	

## Install step:

1. Inject ② into ③, referring the instruction of battery then cover ①. Finish all instruction step, after injecting, wait thirty minutes.
2. Put ③ into battery box, connect electrode ④ by ⑤ and ⑥ fasten them.
3. Take down ⑦ from vehicle, cover ⑧ and tighen by ⑦.

### Attention:

When you connect the electrode ④ make sure red line connect with "⊕" anode, and green line connect with "⊖" cathode.